

Automatic Sensor Faucet User Manual

Before You Begin

- First, we present you our most sincere gratitude for choosing our product. Please read this manual carefully and proceed correctly.

Warning

- People with disabilities, mental disabilities, or lack of common sense (including children) should use this product under supervision of assigned personnel.
- Do not use loose power sockets. Failure to do so may result in a fire or electric shock.
- Never splash water on the power plug or the controller. The auto faucet is an electrical appliance, this may cause product malfunction.
- Do not use a power source other than the specified power source (AC 220 V-240 V). Failure to do so may result in a fire or electric shock.
- Do not exceed the rated power of the socket or patch panel. Failure to do so may result in a fire.
- Do not bend the power cord, place heavy objects on the cord, nor handle improperly. Failure to do so may result in a fire.

Prepare for Installation

For new installations, assemble the faucet to the sink before installing the sink.

For uneven mounting surfaces (such as tile grout lines), apply a suitable sealant under the faucet. Do not use petroleum-based sealant.

1. Caution

- ①. Before you install it, please check the water flowing through angle valve whether is clean. If the water is clean, please close it. If not, please keep the water flowing till it becomes clean, then close the angle valve.
- ②. Please do not mount reflective objects such as stainless steel products on the wall opposite the sensor window to avoid affecting the normal operation of the sensor.
- ③. Please do not install the faucet in direct sunlight or under strong lighting to avoid a decrease in sensing function.
- ④. Please do not use untreated sewage or water sources with a high presence of debris to avoid clogging the solenoid valve and affecting its normal operation.
- ⑤. Due to the presence of internal electronic circuits, please do not immerse the faucet in water.
- ⑥. Please ensure that the connection between the faucet pipe and the water inlet valve is clean and free from impurities to avoid clogging the solenoid valve and affecting its normal operation.
- ⑦. Please ensure that the water outlet nozzle and the basin drain are in a right-angle position to prevent water from splashing outside the basin.
- ⑧. Please use 1.5V alkaline batteries.
- ⑨. Different brands and different levels of battery age should not be mixed and used together.
- ⑩. After the whole installation, please conduct the strict water and pressure testing to ensure that there is no water leakage from the inlet and outlet interfaces. When the water pressure is below 0.05Mpa, a pressure boosting device should be installed to avoid a decrease in flushing effect. When the water pressure is over 0.6Mpa, a pressure reducing device should be installed to avoid the damage to the sensor.

2. Parameters

Power	DC 6V(AC 220V) Optional
Power Static	≤0.5mW(DC 6V)
Consumption	≤2.5mW(AC 220V)
Sensing Range	Initial setting at 20cm
Water Pressure	0.1~0.6Mpa
Temperature Range	1~45°C
Pipe Diameter	G1/2DN15

3.Product Function

- ①. Automatic Flushing--Infrared induction auto on and off.
- ②. Time-out Protection-- When the washing time exceeds 60s, it will auto off to avoid water wasting.
- ③. Low current protection--When the battery power is not enough to ensure the normal operation of the sensor, the indicator flashes quickly to reminder the replacement of a new battery.

4.Product Characteristics

- ①. Intelligent--Turning on & off the water is completed by the sensor automatically.
- ②. Hygiene-- You do not need to touch any switch or parts to avoid cross infection and provide a healthy lifestyle.
- ③. Water saving--Round it off is the precision and it can help you reduce water bills.
- ④. Power saving--Operated by 4 pcs AA Alkaline battery and can meet for more than 3000 times use since you change the new battery.

5.Parts Name

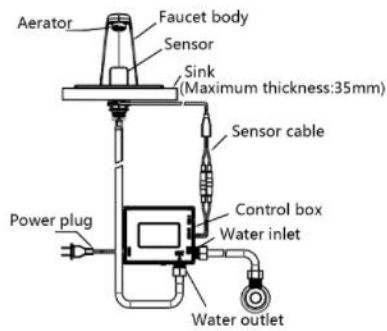

Product body and Accessories

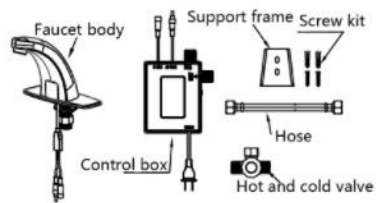

6. Installation for Control Box

Diagram for Control Box

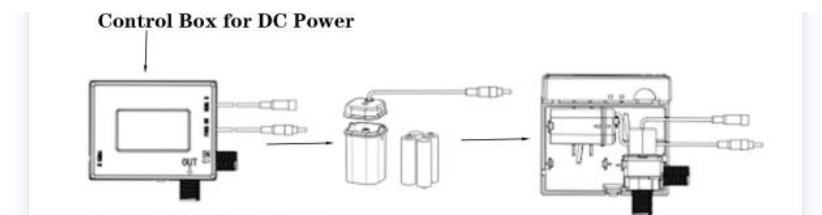
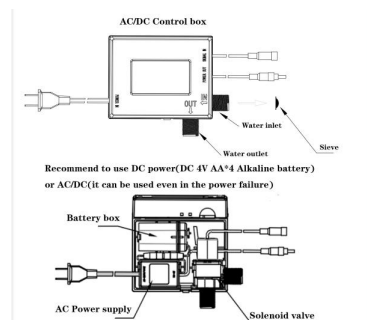

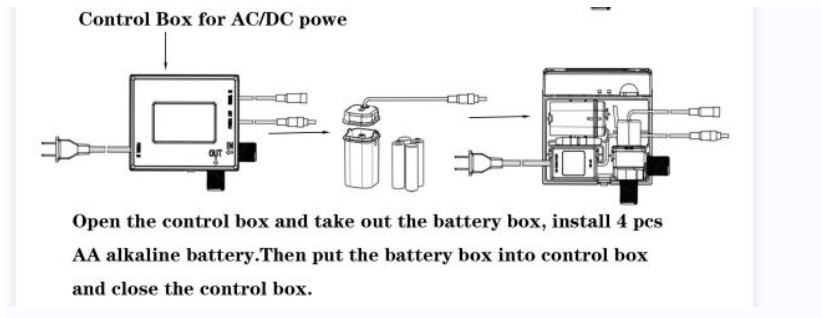

Warm Reminder:

The faucet will automatically adjust its sensing range within 1 minute after being powered on. During this period, please refrain from using the sensor and avoid placing any obstacles in the basin to prevent them from affecting the adjustment of the sensor to the correct sensing range.

7. Installation Step

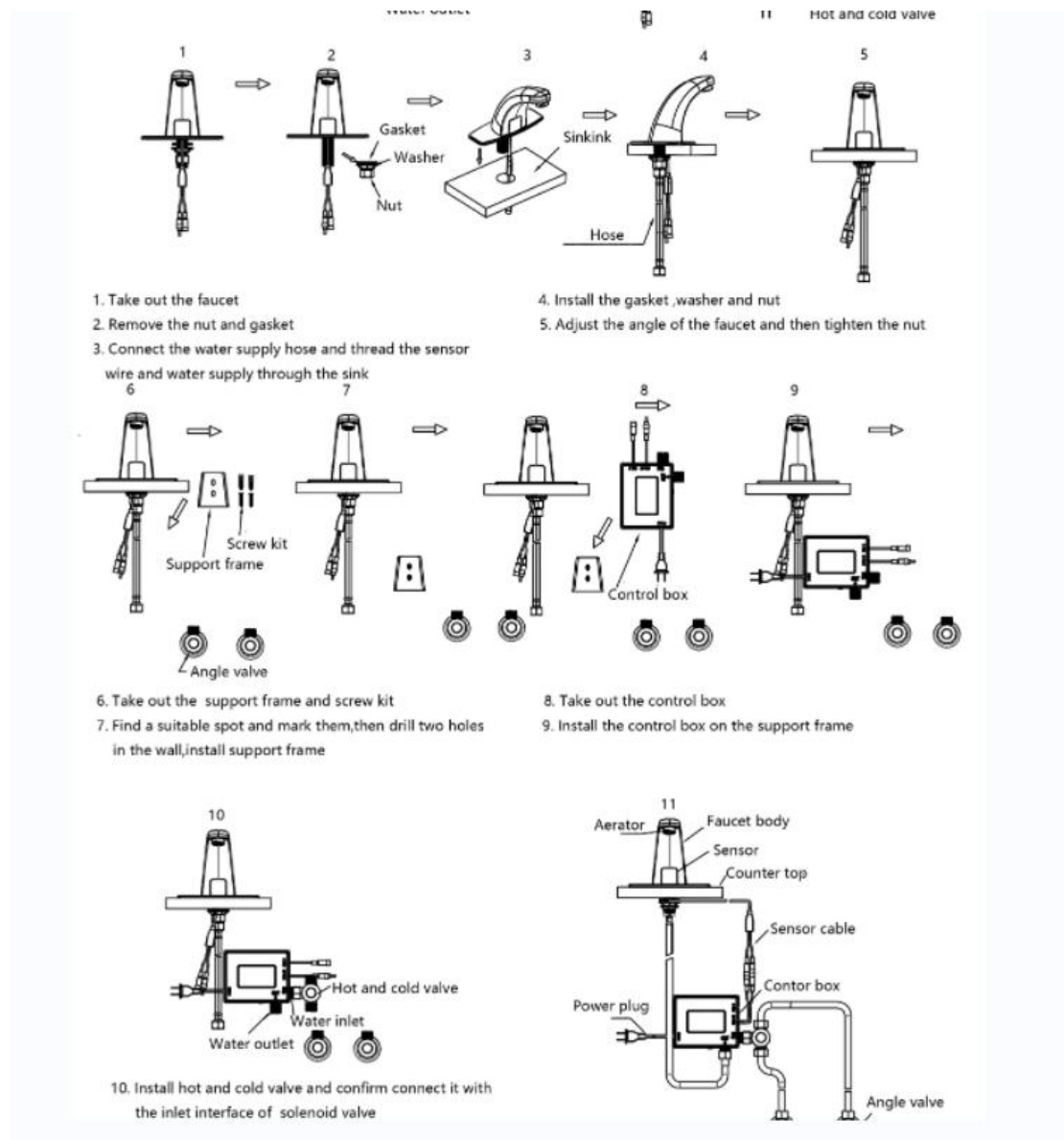

8.Maintenance methods

- ①.If the faucet aerator is clogged and the water flow is reduced, please purchase a replacement spout separately.
- ②.If the solenoid valve is clogged and the water flow is reduced, please remove the solenoid valve, flush the internal grooves, and reinstall it. If the issue persists, consider purchasing a new solenoid valve.
- ③.Do not use corrosive cleaning agents to clean the surface of the faucet.
- ④.Warranty: 1 Year

9.Troubleshooting

Problem	Please check	Solution	Page number
Water will not flow	Indicator light is off	Battery polarity is reversed or installed wrong.	Make sure install the battery correctly
		The line connection is incorrect	Please connect the wire according to user manual
		No electricity	Please make sure the socket is powered on.
		The wires were damaged during installation	Check the wire or apply for warranty
	Indicator light is on	No water supply	Check whether the angle valve is opened.
		The wire of solenoid valve is not connected correctly.	Please confirm whether the solenoid valve works normally. If not, please check whether the wire connection is right.
		The filter is too dirty and clogged	Clean the filter
	Solenoid valve is clogged	Clean the solenoid valve	
Indicator light flashes	Insufficient power supply	Change new battery	
Water can not stop flowing	Obstacle blocked	Remove the obstacle	
	Defective sensor module	Change sensor module	
	Solenoid valve clogged	Clean solenoid valve	
	Defective solenoid valve	Change solenoid valve	
Water rate is too small or Water dripping	Low water pressure	Reset water pressure	
	Solenoid valve clogged	Clean solenoid valve	
Excessive water flow	High water pressure	Reduce the water volume	
		Adjust the water pressure	
Turn on/off automatically	Sensor distance is too long	Please adjust sensor distance according to the installation condition	
	Affected by the installation environment	Check whether the installation environment is directly exposed to strong light or near reflective objects (such as mirror, smooth steel, etc.)	

